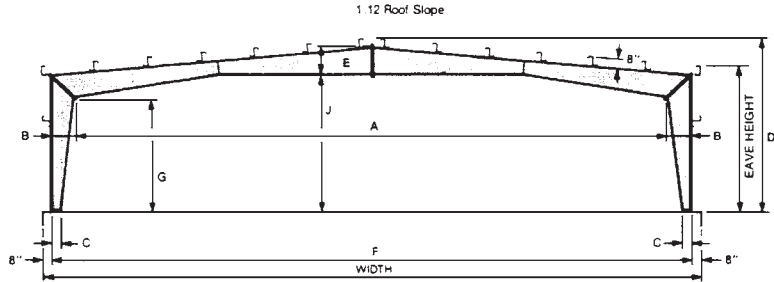

FIGURE 4.8 Various column profiles. (*VP Buildings.*)



FIGURE 4.9 This open-front industrial facility is ideally suited to single-span rigid-frame construction. (*Photo: Maguire Group Inc.*)



NOTE: PURLIN AND GIRT DEPTHS DEPENDENT ON DESIGN REQUIREMENTS.

WIDTH	EAVE HEIGHT (ACTUAL)	*20 PSF LL					30 PSF LL					40 PSF LL				
		A	D	E	G	J	A	D	E	G	J	A	D	E	G	J
30	10'-0"	27'-1"	11'-3"	9'	8'-8"	9'-10"	25'-11"	11'-3"	1'-0"	8'-1"	9'-7"	25'-7"	11'-3"	1'-2"	7'-11"	9'-5"
	12'-0"	27'-1"	13'-3"	9'	10'-8"	11'-10"	25'-11"	13'-3"	1'-0"	10'-1"	11'-7"	25'-7"	13'-3"	1'-2"	9'-11"	11'-5"
	14'-0"	27'-1"	15'-3"	9'	12'-8"	13'-10"	25'-11"	15'-3"	1'-0"	12'-1"	13'-7"	25'-7"	15'-3"	1'-2"	11'-11"	13'-5"
	16'-0"	27'-1"	17'-3"	9'	14'-8"	15'-10"	25'-11"	17'-3"	1'-0"	14'-1"	15'-7"	25'-7"	17'-3"	1'-2"	13'-11"	15'-5"
	20'-0"	28'-9"	21'-3"	9'	18'-6"	19'-10"	25'-11"	21'-3"	1'-0"	18'-1"	19'-7"	25'-7"	21'-3"	1'-2"	17'-11"	19'-5"
40	10'-0"	36'-1"	11'-8"	9'	8'-2"	10'-3"	35'-1"	11'-8"	1'-2"	7'-8"	9'-10"	34'-7"	11'-8"	1'-5"	7'-6"	9'-7"
	12'-0"	36'-1"	13'-8"	9'	10'-2"	12'-3"	35'-1"	13'-8"	1'-2"	9'-8"	11'-10"	34'-7"	13'-8"	1'-5"	9'-6"	11'-7"
	14'-0"	36'-1"	15'-8"	9'	12'-2"	14'-3"	35'-1"	15'-8"	1'-2"	11'-8"	13'-10"	34'-7"	15'-8"	1'-5"	11'-6"	13'-7"
	16'-0"	36'-1"	17'-8"	9'	14'-2"	16'-3"	35'-1"	17'-8"	1'-2"	13'-8"	15'-10"	34'-7"	17'-8"	1'-5"	13'-6"	15'-7"
	20'-0"	36'-1"	21'-8"	9'	18'-2"	20'-3"	35'-1"	21'-8"	1'-2"	17'-8"	19'-10"	34'-7"	21'-8"	1'-5"	17'-6"	19'-7"
50	12'-0"	45'-3"	14'-1"	1'-2"	9'-9"	12'-3"	43'-11"	14'-1"	1'-11"	9'-2"	11'-6"	43'-10"	14'-1"	1'-11"	9'-2"	11'-6"
	14'-0"	45'-3"	16'-1"	1'-2"	11'-9"	14'-3"	43'-11"	16'-1"	1'-11"	11'-2"	13'-6"	43'-10"	16'-1"	1'-11"	11'-2"	13'-6"
	16'-0"	45'-3"	18'-3"	1'-2"	13'-9"	16'-3"	43'-11"	18'-1"	1'-11"	13'-2"	15'-6"	43'-10"	18'-1"	1'-11"	13'-2"	15'-6"
	20'-0"	45'-3"	22'-1"	1'-2"	17'-9"	20'-3"	43'-11"	22'-1"	1'-11"	17'-2"	19'-6"	43'-10"	22'-1"	1'-11"	17'-2"	19'-6"
	24'-0"	45'-3"	26'-1"	1'-2"	21'-9"	24'-3"	43'-11"	26'-1"	1'-11"	21'-2"	23'-6"	43'-10"	26'-1"	1'-11"	21'-2"	23'-6"
60	12'-0"	55'-2"	14'-6"	1'-5"	9'-9"	12'-5"	53'-4"	14'-6"	2'-1"	8'-11"	11'-9"	52'-8"	14'-6"	2'-1"	8'-7"	11'-9"
	14'-0"	55'-2"	16'-6"	1'-5"	11'-9"	14'-5"	53'-4"	16'-6"	2'-1"	10'-11"	13'-9"	52'-8"	16'-6"	2'-1"	10'-7"	13'-9"
	16'-0"	55'-2"	18'-6"	1'-5"	13'-9"	16'-5"	53'-4"	18'-6"	2'-1"	12'-11"	15'-9"	52'-8"	18'-6"	2'-1"	12'-7"	15'-9"
	20'-0"	55'-2"	22'-6"	1'-5"	17'-9"	20'-5"	53'-4"	22'-6"	2'-1"	16'-11"	19'-9"	52'-8"	22'-6"	2'-1"	16'-7"	19'-9"
	24'-0"	55'-2"	26'-6"	1'-5"	21'-9"	24'-5"	53'-4"	26'-6"	2'-1"	20'-11"	23'-9"	52'-8"	26'-6"	2'-1"	20'-7"	23'-8"
70	12'-0"	63'-11"	14'-11"	1'-9"	9'-2"	12'-6"	62'-6"	14'-11"	2'-5"	8'-7"	11'-10"	61'-10"	14'-11"	2'-9"	8'-3"	11'-6"
	14'-0"	63'-11"	16'-11"	1'-9"	11'-2"	14'-6"	62'-6"	16'-11"	2'-5"	10'-7"	13'-10"	61'-10"	16'-11"	2'-9"	10'-3"	13'-6"
	16'-0"	63'-11"	18'-11"	1'-9"	13'-2"	16'-6"	62'-6"	18'-11"	2'-5"	12'-6"	15'-10"	61'-10"	18'-11"	2'-9"	12'-3"	15'-6"
	20'-0"	63'-11"	22'-11"	1'-9"	17'-2"	20'-6"	62'-6"	22'-11"	2'-5"	16'-6"	19'-10"	61'-10"	22'-11"	2'-9"	16'-3"	19'-6"
	24'-0"	63'-11"	26'-11"	1'-9"	21'-2"	24'-6"	62'-6"	26'-11"	2'-5"	20'-6"	23'-10"	61'-10"	26'-11"	2'-9"	20'-3"	23'-5"
80	12'-0"	73'-7"	15'-4"	1'-11"	9'-0"	12'-9"	71'-10"	15'-4"	2'-7"	8'-3"	12'-1"	71'-2"	15'-4"	2'-10"	7'-11"	11'-10"
	14'-0"	73'-6"	17'-4"	1'-11"	11'-0"	14'-9"	71'-10"	17'-4"	2'-7"	10'-3"	14'-1"	71'-2"	17'-4"	2'-10"	9'-11"	13'-10"
	16'-0"	73'-6"	19'-4"	1'-11"	13'-0"	16'-9"	71'-10"	19'-4"	2'-7"	12'-3"	16'-1"	71'-2"	19'-4"	2'-10"	11'-11"	15'-10"
	20'-0"	73'-6"	23'-4"	1'-11"	17'-0"	20'-9"	71'-10"	23'-4"	2'-7"	16'-3"	20'-1"	71'-2"	23'-4"	2'-10"	15'-11"	19'-9"
	24'-0"	73'-6"	27'-4"	1'-11"	21'-0"	24'-9"	71'-10"	27'-4"	2'-7"	20'-3"	24'-1"	71'-2"	27'-4"	2'-10"	19'-11"	23'-9"
100	14'-0"	92'-2"	18'-2"	2'-4"	10'-5"	15'-1"	90'-10"	18'-2"	2'-10"	9'-9"	14'-8"	89'-10"	18'-2"	3'-5"	9'-4"	14'-1"
	16'-0"	92'-2"	20'-2"	2'-4"	12'-5"	17'-1"	90'-10"	20'-2"	2'-10"	11'-9"	16'-7"	89'-10"	20'-2"	3'-5"	11'-4"	16'-1"
	20'-0"	92'-2"	24'-2"	2'-4"	16'-5"	21'-1"	90'-10"	24'-2"	2'-10"	15'-9"	20'-7"	89'-10"	24'-2"	3'-5"	15'-3"	20'-0"
	24'-0"	92'-2"	28'-2"	2'-4"	20'-5"	25'-1"	90'-10"	28'-2"	2'-10"	19'-9"	24'-7"	89'-10"	28'-2"	3'-5"	19'-4"	24'-0"
	120	14'-0"	110'-10"	19'-0"	2'-10"	9'-9"	15'-6"	109'-10"	19'-0"	3'-4"	9'-4"	15'-0"	108'-10"	19'-0"	4'-2"	8'-10"
16'-0"		110'-10"	21'-0"	2'-10"	11'-9"	17'-6"	109'-10"	21'-0"	3'-4"	11'-4"	17'-0"	108'-10"	21'-0"	4'-2"	10'-10"	16'-2"
20'-0"		110'-10"	25'-0"	2'-10"	15'-9"	21'-6"	109'-10"	25'-0"	3'-4"	15'-4"	21'-0"	108'-10"	25'-0"	4'-2"	14'-10"	20'-2"
24'-0"		110'-10"	29'-0"	2'-10"	19'-9"	25'-6"	109'-10"	29'-0"	3'-4"	19'-4"	25'-0"	108'-10"	29'-0"	4'-2"	18'-10"	24'-2"
30'-0"		110'-10"	35'-0"	2'-10"	25'-9"	31'-6"	109'-10"	35'-0"	3'-4"	25'-4"	31'-0"	108'-10"	35'-0"	4'-2"	24'-10"	30'-2"

*12 PSF LL FRAME

Dimensions shown are for 25' bays, 20' and 30' bays also available. Building components and dimensions shown are subject to change due to final design.

FIGURE 4.10 Typical dimensions of low-profile single-span rigid frame. (Metallic Building Systems.)